

BM7 Series

Slam-Shut Valve

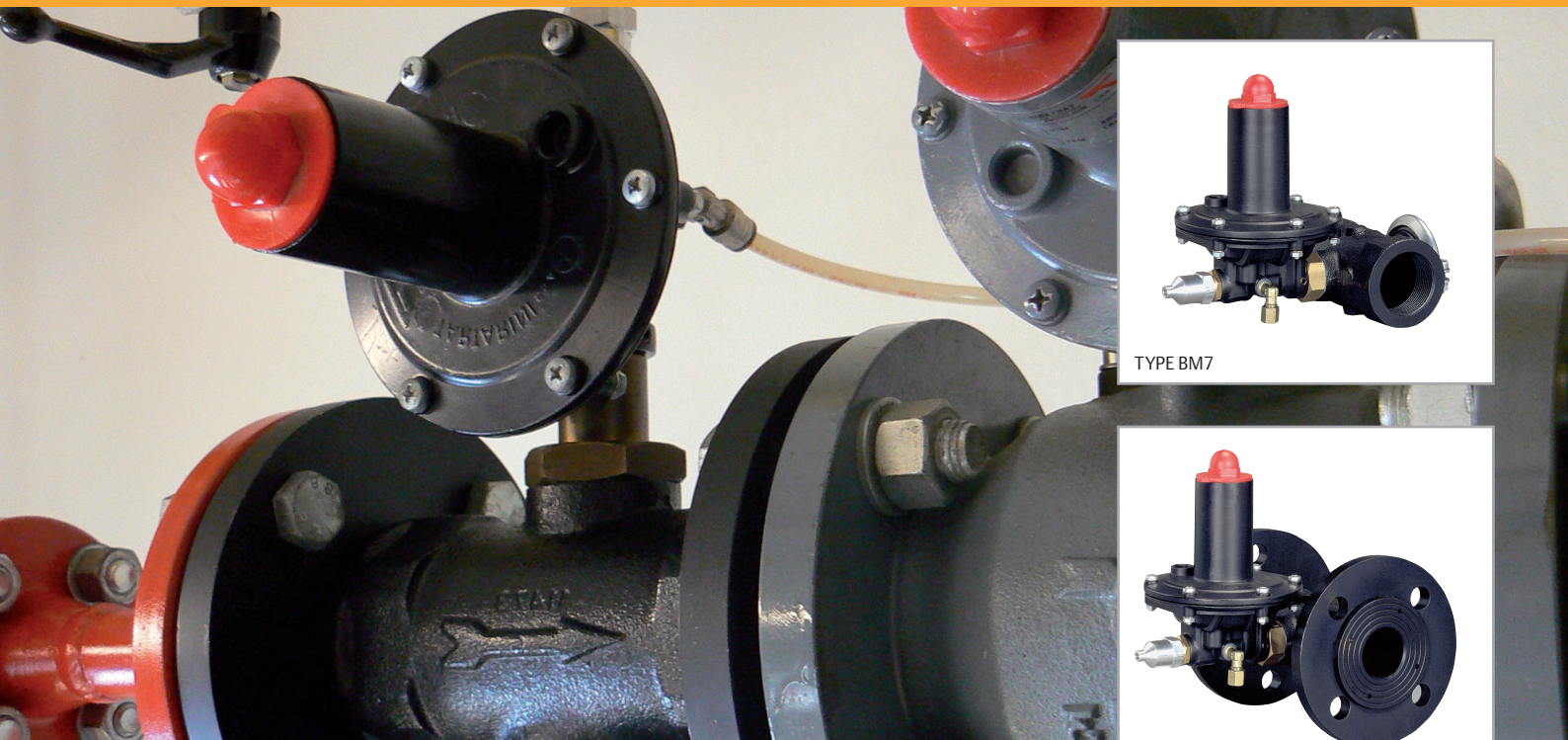

Introduction

The BM7 Series slam-shut valves are automatic isolating elements suitable for installation as safety devices in regulating stations.

The slam-shut valves in the BM7 series are used in filtered natural gas reduction stations.

They can also be used with air, propane, butane, nitrogen, and other non-aggressive gases.

The BM7 Series is in conformity with the Pressure Equipment Directive PED 97/23/EC and is classified under Category IV.

Available Versions

- DN 1 1/2", 2" GAS - Threaded Body
- DN 40, 50 PN 16 - Flanged Body
- DN 50 ANSI 150 - Flanged Body (on request)

Features

- Ease of Installation
- Ease of Maintenance
- High Operation Accuracy



www.emersonprocess.com/regulators



EMERSON. CONSIDER IT SOLVED.™

BM7 Series

Dimensions (mm) , Weights (kg) and Materials

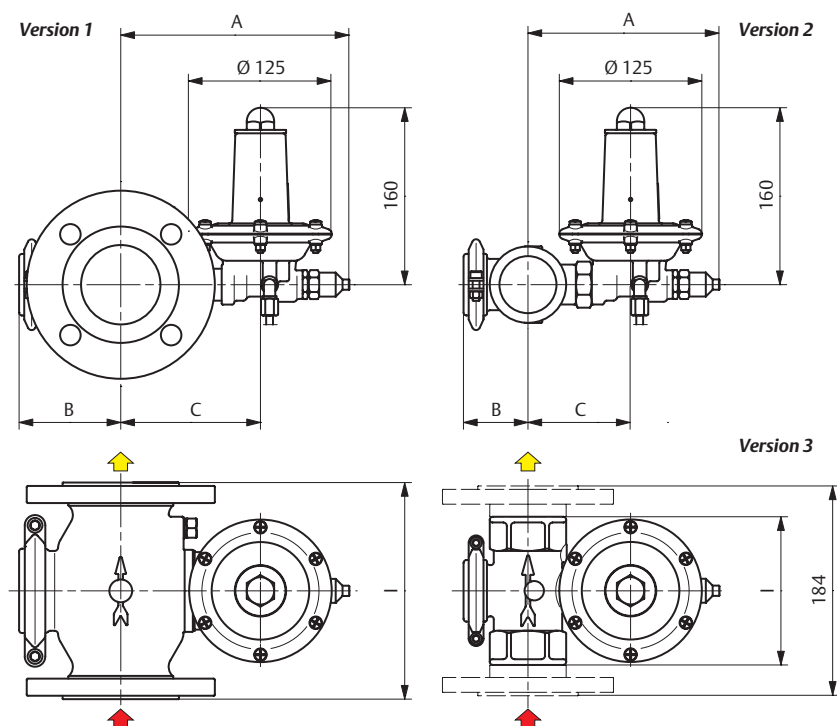

Dimension

TYPE	A	B	C	I	Version	Weight
BM7/ 1 1/2"	165	57	90	130	2	3
BM7/40-FS	165	57	90	184	3	7
BM7/2"	190	85	120	160	2	5
BM7/50-F	195	90	125	190	1	13

Materials

Threaded body: Spheroidal cast iron
 Flanged body: Spheroidal cast iron or steel
 Covers: Aluminium
 Seat: Brass
 Diaphragm: Fabric Nitrile (NBR) rubber

Specifications

Permissible Inlet Pressure

Up to 14 bar

Pressure Ranges

Version with Type OS/66 Shutoff

Minimum Pressure Set Range: 0.007 to 0.4 bar

Maximum Pressure Set Range: 0.025 to 0.5 bar

Version with Type OS/66-AP Shutoff

Minimum Pressure Set Range: 0.1 to 2.5 bar

Maximum Pressure Set Range: 0.2 to 5 bar

Accuracy Class

Up to $\pm 1\%$

Response Time

< 1 s

Temperature Capabilities

Standard Version:

Working: -10° to 60°C

Low Temperature Version:

Working: -20° to 60°C

Approximate Weights

3 to 13 kg

Emerson Process Management Regulator Technologies, Inc.

Americas - Worldwide Headquarters

310 East University Drive
 McKinney, Texas 75069-1872 USA

T: +1 800 558 5853

T: +1 972 548 3574

F: +1 972 542 6433

www.emersonprocess.com/regulators

Europe

T: +39 051 4190611

Asia Pacific

T: +65 6770 8337

Middle East

T: +971 4811 8100

0061EN - 09/2012 © 2012 Emerson Process Management Regulator Technologies, Inc.; All Rights Reserved.

Fisher, Emerson Process Management, and the Emerson Process Management design are marks of one of the Emerson Process Management group of companies. All other marks are the property of their respective owners.

Our Global Product Brands:

